



1.25G 1310nm FP LD LC TOSA V1.0

WZLFR10310	1.25G 1310nm FP LD LC TOSA
------------	----------------------------

Features:

- 1310nm MQW-FP laser chip
- Built-in InGaAs monitor photodiode
- coaxial-OSA package with LC connector

Applications:

- Optical communication systems

Absolute Maximum Ratings

Parameter	Symbol	Unit	Min	Max
Operating temperature range	To	°C	-40	85
Storage temperature range	Ts	°C	-40	85
Relative humidity	RH	%	5	95
Reverse voltage(Laser diode)	VRL	V	-	2
Forward current(Laser diode)	I _{FL}	mA	-	2
Reverse voltage(Monitor PD)	V _{RPD}	V	-	20
Soldering temperature*time	-	°C*S	-	260*10

Opt-Electrical Characteristics (T=25°C, unless otherwise noted)

Parameter	Symbol	Unit	Min	Typ	Max	Condition
Threshold current	I _{th}	mA	-	10	15	CW
			-	-	30	CW, over temperature
Operating voltage	V _{op}	V		1.15	1.5	CW, I _{th} +20mA
Slope efficiency	η	W/A	0.25	0.30	-	CW, T=25°C
			0.15	-	-	CW, T=-40~85°C
Peak wavelength	λ _c	nm	1290	1310	1330	CW, T=25°C
			1270	1310	1350	CW, T=-40~85°C
Spectral Width (RMS)	Δλ	nm	-	1.5	3	CW, P _o =5mW
Rise and fall time	T _r /T _f	nS	-	0.3	0.5	P _o =5mW, 10%~90%
Monitor PD current	I _m	uA	100	-	1000	CW, I _{th} +20mA
Monitor PD dark current	I _d	nA	-	-	100	CW, V _{RPD} =5V over temperature
Photodiode capacitance	C	pF	-	10	20	f=1MHz, V _{RPD} =5V
Tracking error	ΔP _f /p _f	dB	-1.5	-	+1.5	APC mode

Dimensions

地址：武汉市东湖高新技术开发区东一产业园 4 号路佛祖岭 3 号厂房 2 楼
 电话：027-81785029
 传真：027-81785029



Pin function and outline diagram

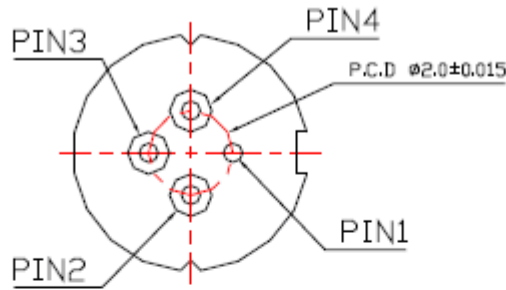
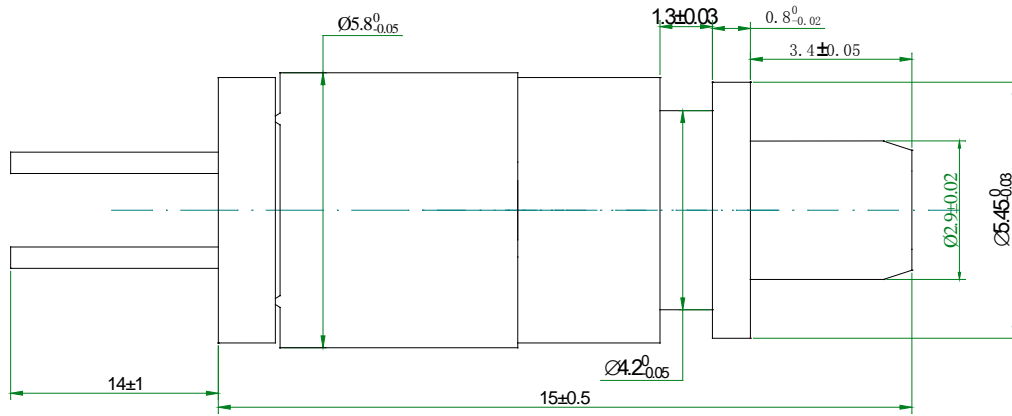

Bottom View

PINOUT

Number	Function
1	Case Gnd
2	Laser Diode Cathode
3	Photodiode Anode
4	Photodiode Cathode & Laser Diode Anode

地址：武汉市东湖高新技术开发区东一产业园 4 号路佛祖岭 3 号厂房 2 楼
电话：027-81785029
传真：027-81785029